



BajaRon's Custom Performance  
Anti-Sway-Bar  
**2013 & 14 Models ONLY**  
**Version 1.1**

**V1.1** - Made for ALL 2013 & 2014 RS, RSS, ST, STS, ST Ltd. Spyders  
*WILL NOT FIT 2013 Spyder-RT, RTS, RT Ltd. or any Pre-2013 Models*

As with any performance modification, go slowly and take the time to learn what differences this Sway Bar has made in how your Spyder handles as you ride. ***It is your responsibility to ride responsibly.***

The installation of your new **BajaRon** Custom Performance Anti Sway-Bar is a straightforward removal of the original bar and replacement with the new bar. (Anti-Sway Bar and Sway Bar are interchangeable terms)

**Note:** Directions are given as if sitting on the Spyder in the driving position unless otherwise indicated.  
Part #'s which **MUST BE REMOVED** for this install are circled in **RED (Diagram #1)**  
Additional Assemblies which you may choose to remove (optional) are circled in **GREEN**

**Important!** It is not necessary, ***nor is it advisable*** to remove the front trunk (Frunk).

### Installation Instructions

**1. MOST IMPORTANT!** - Set Parking Brake! You will need 20 ~ 22 inches of clearance below the bottom of the Frame Tube that holds the sway bar. This means you will need to raise the Spyder 16"~18". ***You do not need this much clearance until you get to step #7*** where the original sway bar is removed and the new Custom sway bar is installed.

Lifting the Spyder can be accomplished in a variety of ways including floor jacks, scissor jacks or ramps. It is not necessary to raise the front wheels off of the support surface (i.e.. car ramps or lift table). However, car ramps and solid table lifts may not give an adequate amount of lift.

It is not necessary to lift the rear of the Spyder, but it is **very important** that you stabilize the Spyder so there is no chance of it tipping, slipping, or falling. Jack stands can be used to stabilize the Spyder once lifted.

2. Remove the 2 Deflector Panels (#464 & #474) and LH Skid Plate (#470) Not to be confused with the Front Skid Plate (#418) which does NOT need to be removed. (See **Diagram #1** below).

3. Remove 2 Bolts (#354) from LH Radiator Molding (#472) and RH Radiator Molding (#473a).

4. Remove Bolts (#3) and Nuts (#4) where the Sway Bar (#70) attaches to the Heim Joint Link (#38). (See **Diagram #2**)  
If you are NOT installing the BajaRon Billet Aluminum Heim Joint Link Set, skip to next step.

Installing the BajaRon Billet Aluminum Heim Joint Links. Remove upper 13mm bolts. Using the same Nuts and Bolts, replace OEM links with BajaRon links at the top connection only. There is no particular orientation of the BajaRon Link. Mount them any way you like. Tighten these connections.

5. Remove Bolts (#9) and nuts (#6) (**Diagram #2**) which hold the Bushing Blocks (#61) on both sides of the Sway Bar.
6. Move Sway Bar to your right (looking from the front of the Spyder). Manipulate the sway bar arm past the tab on the LH Radiator Molding (#472) where you removed bolt (#354). Slide the sway bar just far enough so the Bushing Block (#61) clears the frame tube. Separate the 2 Bushing halves and remove them from the Sway bar. Repeat for other side. If you feel this is too difficult you may want to remove the Radiator Molding assemblies (#472) & (#473a).
7. Remove OEM sway bar and install BajaRon Custom Performance sway bar.

**WARNING! – Be sure the Spyder is secure and stabilized so that it cannot tip, slip or fall as you raise it. You will need about 22" of clearance below the bottom of the Frame Tube where the Sway Bar is held. The amount of clearance needed will become obvious as you proceed.**

Raise the front of your Spyder 16"~18" so that you have 20"~22" of clearance below the Frame Tube where the Sway Bar mounts. Be careful to **SAFELY** raise and stabilize the Spyder. Weight does not need to be lifted off the tires.

8. With the sway bar arms hanging straight down, move the bar as far as possible to one side until it drops out of the sway bar frame tube and remove it. You will have to work the bar past the appropriate mounting tab.
9. Reverse this same procedure to install the New BajaRon Custom Performance Sway Bar. You can start from either side but the following instructions start on the Left side of the Frame Tube when facing the Spyder from the front.

With the Bar hanging vertically and both arms facing inward, insert the upper bar arm into the Left Side of the Frame Tube moving the lower end of the bar up and in. The slot at the top of the Frame Tube will allow the inserted arm of the sway bar to pass through the Frame Tube and out the other side.

10. When the inserted sway bar arm is all the way through and is clear of the Frame Tube it is time to install the White Bushing Blocks (pictured below). Be sure to orient them correctly (**Red Arrows**).



With the sway bar horizontal and the inserted arm clear of the Frame Tube, and **BEFORE** you work the opposite Sway Bar Arm past the tab on the RH Radiator Molding (#473a), spread one of the supplied Bushing Blocks (White) and fit it over the left side of the Sway Bar (looking from the front of the Spyder). Place the Bushing Block between the frame tube and the Tab on the RH Radiator Molding (#473a).

11. Now work the Left Hand Sway Bar Arm past the RH Radiator Molding Tab.
12. Slide the mounted Bushing Block into the Frame Tube being sure to orient it correctly.
13. Now, slide the Sway Bar to your Right working the Right Sway Bar Arm past the tab on the LH Radiator Molding (#472) so that you can install the White Bushing Block onto the Sway Bar as you did the Left side.
14. Work the Right Side Sway Bar Arm back again to your left past the LH Radiator Molding (#472) and slide the Bushing Block into the Frame Tube being sure to orient it correctly.
15. Install the Bushing Block Bolts (#9) and Nuts (#6) on each side (do not tighten yet).
16. Install the Limiting Collar Clamps (included). Remove the Allen head bolts from the split clamp and place it onto the sway bar next to the outside edge of one Bushing Block. Reinstall both Allen head bolts but **DO NOT TIGHTEN!**



**Collar  
Clamp**

17. Align Sway Bar ends with Links (**#38**). Links mount to the OUTSIDE of the Sway Bar. Move bar left or right until links are vertical (pictured). When links are vertical your bar is centered. Install Bolts (**#9**) and Nuts (**#6**) Do not tighten.

#### **Sway Bar Centering**

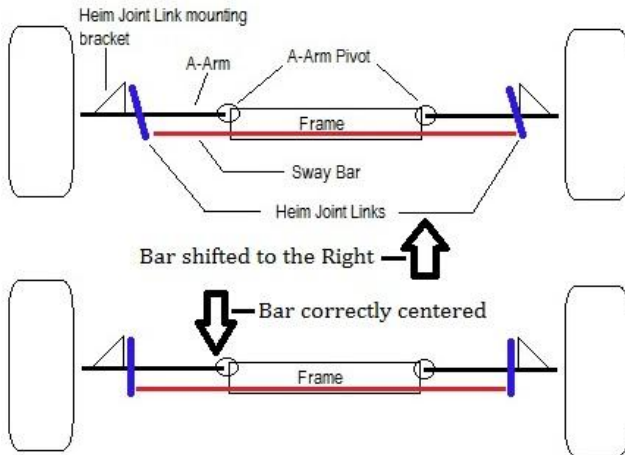

18. Slide one Collar Clamp against the corresponding Bushing Block. Being sure your bar is still centered, tighten both Allen head bolts on this Collar evenly so the gap on each side is equal. Repeat this process on the other side.

19. Tighten the Bushing Block Nuts (**#6**) and Bolts (**#9**) until the lower portion of the slit in the Bushing Block is closed.

20 Tighten Heim Joint Link Bolts (**#3**) and Nuts (**#4**) Check the Upper Heim Joint Link bolts for tightness.

21. If you have removed either or both of the Radiator Molding assemblies (**#472 or #473a**) replace them. Remember to replace the Radiator Grill(s) (**#475 & #476**) if they were removed. If you did not remove these optional assemblies, simply replace Bolts (**#354**) on both sides for Tabs on Radiator Moldings (**#472 & #473a**).

22. Replace LH Skid Plate (**#470**) and the LH and RH Deflector Panels (**#464 & #474**)

23. Once you are satisfied that everything has been properly replaced and secured your installation is complete and you are **Ready To Ride!**

Your BajaRon Custom Performance Anti Sway-Bar works only during turns or when side force is applied to the Spyder (as in crosswinds or when passing large trucks). The harder the turn, crosswind, etc., the harder your new sway-bar will work for you.

The Sway-Bar will not lift your Spyder, change ride height, or make the ride stiff or harsh. These functions are controlled by your shocks and shock springs.

I recommend you run 18~20 psi in the front tires and 28~32 psi in the rear. You may want to re-adjust your shock springs to a lower setting, especially if you had raised the setting to reduce body roll (Lean Angle) and dive. Now that you have installed the BajaRon Custom Performance Sway Bar, a stiffer shock spring setting may not be necessary. This will restore a smoother, more comfortable ride.

If you have any questions you may email me at [fyredad@hotmail.com](mailto:fyredad@hotmail.com) or you may call me at 423-552-3720 Ron (bajaron)

Diagram # 1

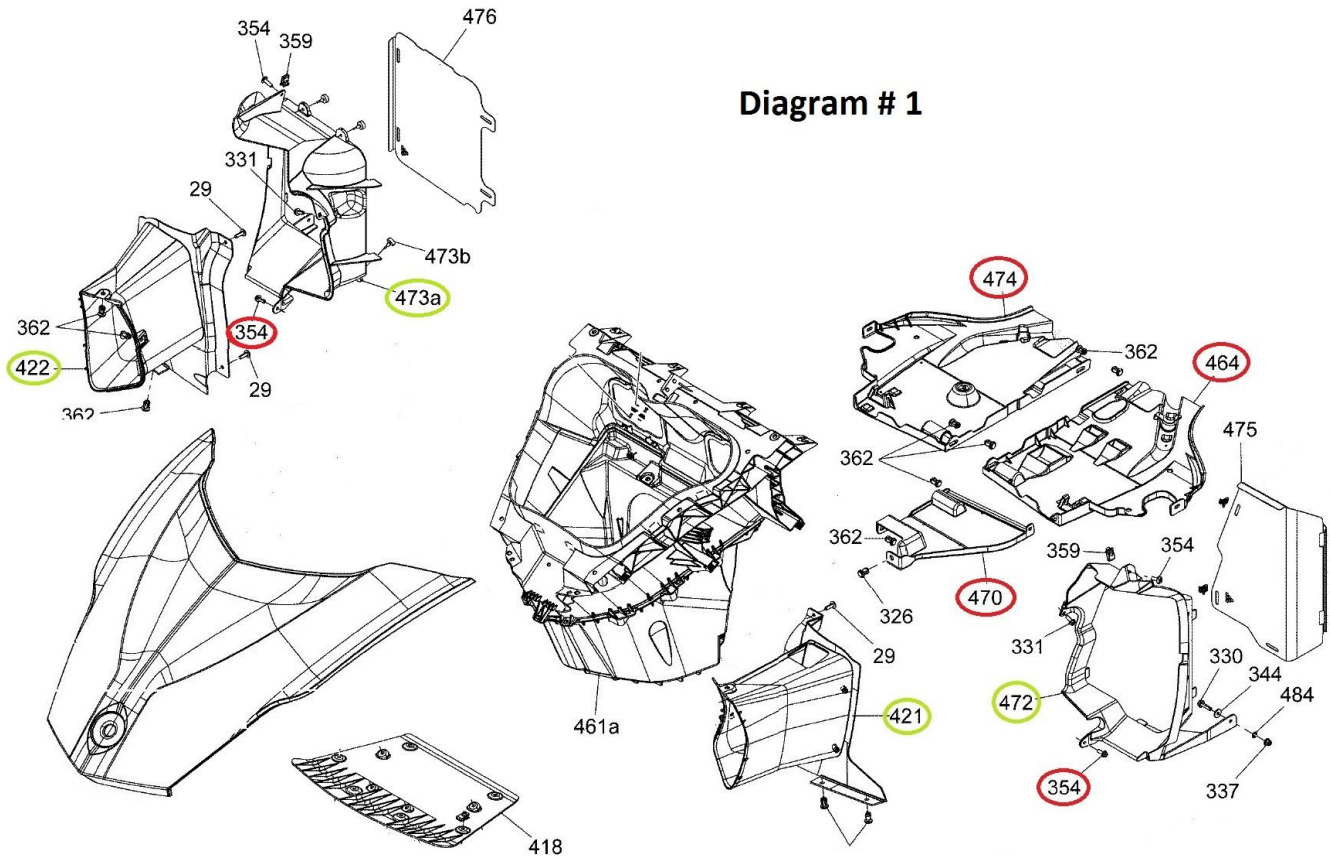

Diagram # 2

